



# EVERLOG™ SIDING

WORRY FREE CONCRETE LOG SIDING

[www.EverLogs.com](http://www.EverLogs.com)

T: 877.257.5647

F: 877.698.0700



# What is EverLog™ Siding?

EverLog™ Siding is worry-free concrete log siding.

EverLog™ Siding is the worry free and environmentally friendly solution to wood log siding. Made of composite materials our exterior logs offer the exact character, texture and warm appeal of quality wood logs. EverLog™ Siding also eliminates the costly maintenance, and susceptibility to fire, mold, insects and other problems commonly associated with wood log siding.

## Features and Benefits

- ♦ *Worry Free*
- ♦ *Fire Resistant*
- ♦ *Resistant to insects and woodpeckers*
- ♦ *Resistant to mold and other decay*
- ♦ *Superior performance in wildfires*
- ♦ *Substantially reduces maintenance and operating cost over life of the structure*
- ♦ *Easy installation with common tools*

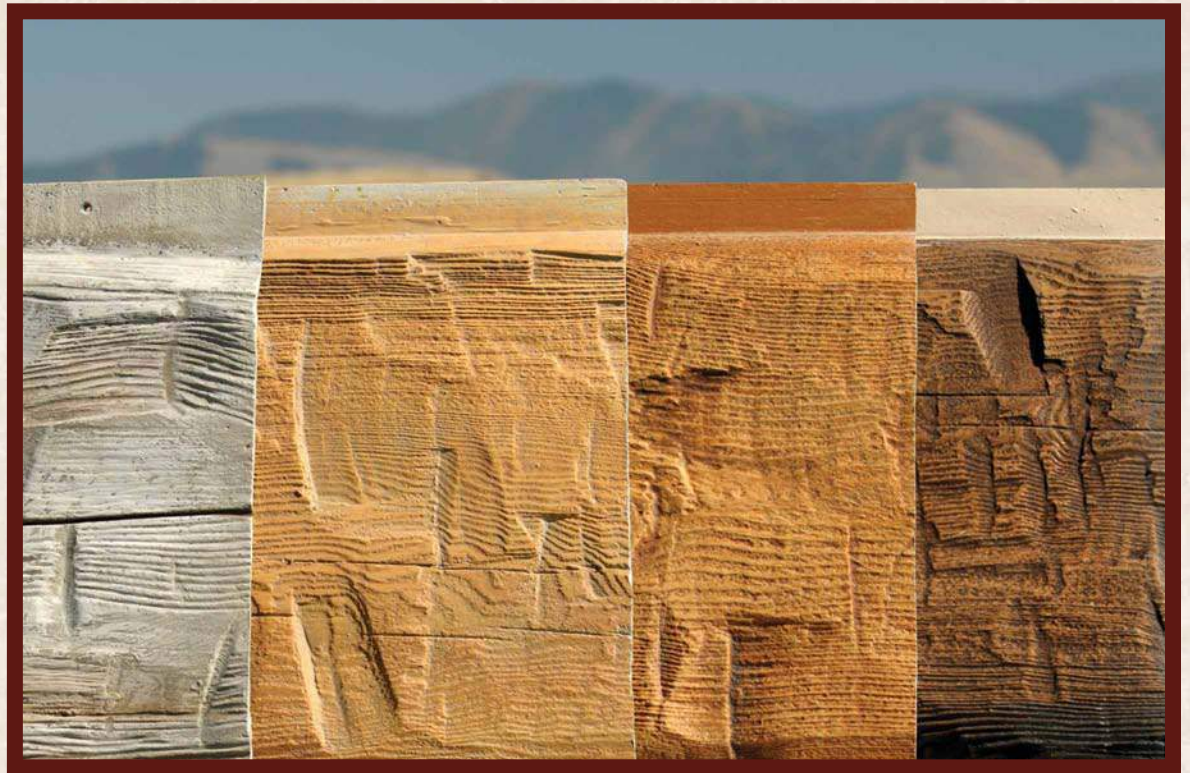

**Available Profile Colors:** (from left to right) *Weathered Gray, Tan, Golden and Natural Brown*  
16" Hand Hewn Profile Shown



# Specifications

## General Description

EverLog™ Siding provides the user with an incredibly realistic, three dimensional, wall siding product offering a high degree of long term performance.

## Style

Full size, exact cast replicas of 16" hand hewn logs.

## Sizes

Siding panel size: Width 16" (41cm) nominal. Length: 12'-0" (366cm) +/- 1/4" Corner post face size 7 1/2" (19.1cm) x 7 1/2" (19.1 cm). Standard Post height is 10' (304.8cm)

## Thickness

Material 1/4" (.635cm) thick nominal. Panel profile 1" - 1 3/4" (2.5-4.4cm)

## Composition

EverLog™ Siding is composed of a proprietary mixture of fiber reinforced cement and other specialty additives.

## Technical Attributes

EverLog™ Siding has been comprehensively tested and meets all relevant ASTM tests, and all local and regional building codes.

## Warranty

EverLog™ Siding provides a 50 year transferable limited warranty. Please visit [www.EverLogs.com](http://www.EverLogs.com) to view the complete warranty.

## Technical Service

Call 1-877-257-5647 8:00am-5:00pm MST, Monday—Friday.

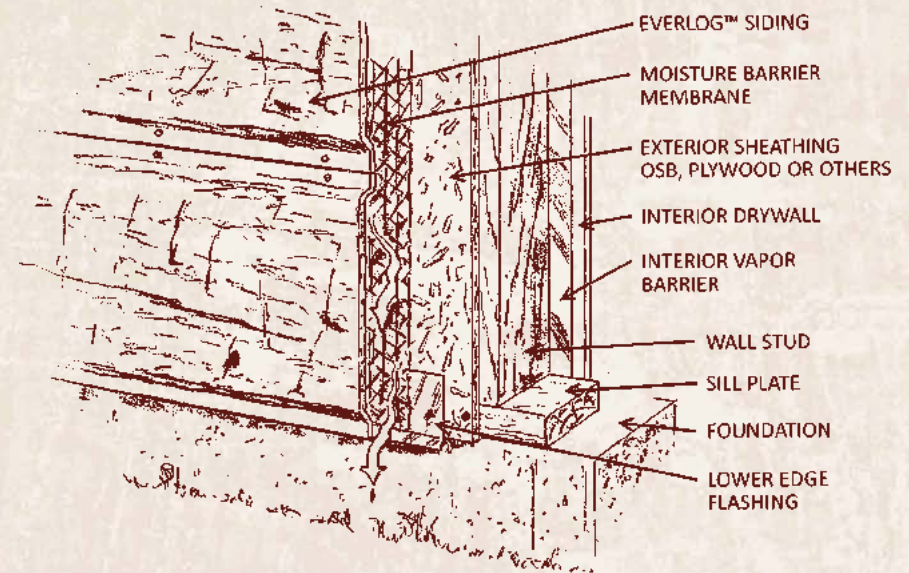

Another Quality Product By



**EVERLOG  
SYSTEMS™**  
WORRY FREE  
CONCRETE LOGS

P.O. Box 16537 Missoula, Montana 59808 [www.EverLogs.com](http://www.EverLogs.com)